

PT-15XL Mechanized Torch



- Heavy-duty performance, cuts up to 6 in. (152.4 mm)
- Designed for exceptional durability
- Precision engineering
- Excellent nozzle and electrode concentricity
- 180° in-line mechanized torch
- Water cooled/water injected
- Pilot arc starting - even starts on paint
- Uses Nitrogen, Oxygen, or H-35 for plasma gas



Ordering Information

PT-15XL

4.5 ft. (1.4 m) lead.....	21307
6 ft. (1.8 m) lead.....	21304
6 ft. (1.8 m) lead, series "A"	20762
12 ft. (3.7 m) lead.....	21305
15 ft. (4.6 m) lead.....	21301
17 ft. (5.2 m) lead.....	21306
20 ft. (6.1 m) lead.....	21302
25 ft. (7.6 m) lead.....	21303
PT-15XL less leads.....	16365

This ruggedly designed torch provides excellent performance for everyday use as part of a specially configured ESAB Smart Plasma (ESP) heavy mechanized cutting system.

Specifications

PT-15XL	
Current capacity:	
Oxygen	360A @ 100% duty cycle
Nitrogen	750A @ 100% duty cycle
Argon-Hydrogen	1000A @ 100% duty cycle
Start gas pressure, psig	100 to 125
Cut gas pressure, psig	100 to 125
Length of service leads, ft. (m)	4.5 (1.4) 6 (1.8) 12 (3.7) 15 (4.6) 17 (5.2) 20 (6.1) 25 (7.6)
Dimensions, in. (mm)	11-1/2 (292) length, 2 (50.8) barrel diameter

PT-15XL Mechanized Torch

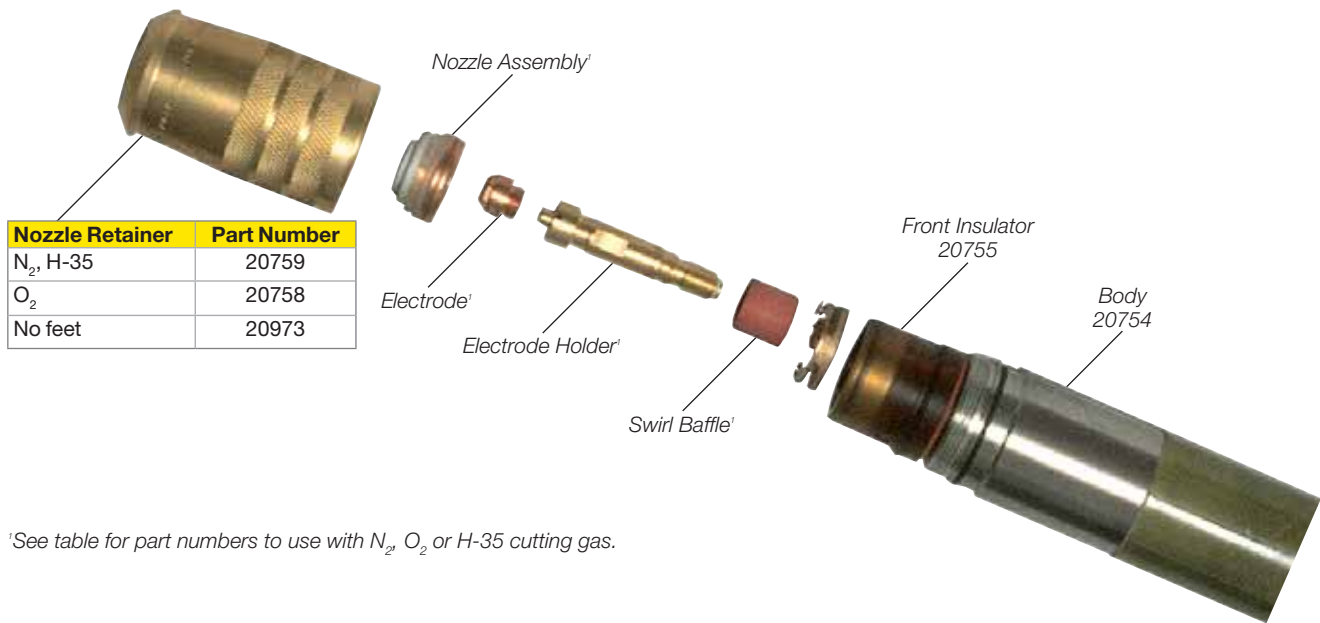

Nozzle Retainer	Part Number
N ₂ , H-35	20759
O ₂	20758
No feet	20973

*See table for part numbers to use with N₂, O₂ or H-35 cutting gas.

Process	Electrode	Electrode Holder	Nozzle Assembly			Swirl Baffles	
			Diameter, in. (mm)	Part Number	Rating	Standard	Optional
Nitrogen with water injection	600236	2075343	.125 (3.2)	2075691	250A	4 Hole Ceramic 948142	4 Hole Plastic 2075341
			.156 (4.0)	2075611	400A		
			.200 (5.0)	2075612	600A		
			.230 (5.8)	2075613	750A		
			.125R (3.2R)	2075692	250A	4 Hole Reverse Ceramic 948143	4 Hole Reverse Plastic 2075360
			.156R (4.0R)	2075614	400A		
			.200R (5.0R)	2075615	600A		
			.230R (5.8R)	2075690	750A		
Argon/Hydrogen H-35	600236	2075343	.250 (6.4)	2075587	875 - 1000A	8 x .067 Ceramic 2075586	
Oxygen with water injection	35666XL	20398	.07 (1.8)	37317	125A	4 Hole Ceramic 948142	None
			.07R (1.8R)	37318		4 Hole Reverse Ceramic 948143	
	20763XL or 35666XL		.099 (2.5)	20751	260A	8 x .067 Ceramic 2075586	4 Hole Ceramic 948142
			.099 (2.5)	21206B		8 x .067 Reverse Ceramic 2075586	4 Hole Reverse Ceramic 948143
			.099R (2.5R)	21207B			
			.099R (2.5R)	20920			
	35666XL		.116 (2.9)	35662	300A 340A	8 x .047 Ceramic 35660	None
			.120 (3.0)	35664		8 x .047 Reverse Ceramic 35661	
			.116R (2.9R)	35663			
			.120R (3.0R)	35665			

ESAB Welding and Cutting Products

USA: www.esabna.com / 1.800.ESAB.123 | Canada: www.esab.ca / 1.877.935.3226 | Mexico: www.esab.com.mx / (81) 8305-3700